



WWW.KRONE-FILTER.DE

KFT® WET AIR FILTER

FOR THE
LOW-DUST ENVIRONMENT



MADE IN EU

... guarantees fast delivery 

Krone
Filtertechnik

RELIABLE PROTECTION FOR MACHINE AND ENVIRONMENT

The company that began in 1990 as a representative of MANN+HUMMEL has now developed into a leading provider of comprehensive filter technology and services. Our core area, the sale of industrial filters, was expanded in 1993 by adding a full range of exhaust after-treatment products as well as trading and assembly services for catalytic converters, soot particle filters and SCR systems. All this is rounded off by an optimised range of services provided by our fitters, ensuring individual customer support.

At our business premises in Achim near Bremen, as well as at 5 additional business locations, more than 25 dedicated employees work under the management of Rainer Krone to develop tailored solutions for meeting our customers' requirements. The industrial filters business unit has companies from virtually every industry among its customers. To ensure intensive customer care, our sales engineers and office staff are highly qualified and a competent contact person is always at your disposal.



OUR VALUES:

„Enthusiasm and joy as well as team spirit and honesty are the basics of our success. Through respect, trust and reliability towards colleagues, customers and suppliers we achieve optimal results and satisfaction.“

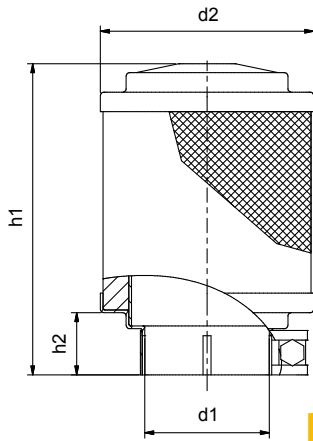

KFT® wet air filters are used for the filtration of intake air in low-dust environments, such as ship engines, power generators and compressors operated in enclosed spaces.

The KFT® wet air filters consist of a knitted steel mesh which must be wetted with oil after each maintenance in order to achieve an optimum filter performance. The cleaning can be carried out optimally with a steam jet device.

DIMENSIONS & ORDER NUMBERS

ITEM NUMBER	M ³ /MIN	D1	D2	H1	H2	WEIGHT (KG)
KF-4301467012	1.4	30 mm (1.18")	80 mm (3.15")	78 mm (3.07")	32 mm (1.26")	0.25
KF-4301867012	1.8	35 mm (1.38")	80 mm (3.15")	90 mm (3.54")	32 mm (1.26")	0.4
KF-4301867022	1.8	40 mm (1.57")	80 mm (3.15")	90 mm (3.54")	32 mm (1.26")	0.4
KF-4303667012	3.6	52 mm (2.05")	107 mm (4.21")	110 mm (4.33")	32 mm (1.26")	0.6
KF-4304667012	4.6	60 mm (2.35")	107 mm (4.21")	128 mm (5.04")	34 mm (1.34")	0.8
KF-4306067012	6	66 mm (2.60")	120 mm (4.72")	140 mm (5.51")	35 mm (1.38")	1.0
KF-4308067102	8	70 mm (2.76")	120 mm (4.72")	175 mm (6.89")	35 mm (1.38")	1.2
KF-4308067112	8	70 mm (2.76")	120 mm (4.72")	175 mm (6.89")	35 mm (1.38")	1.2
KF-4310067012	10	80 mm (3.15")	147 mm (5.79")	180 mm (7.09")	38 mm (1.50")	1.5
KF-4310067112	10	80 mm (3.15")	147 mm (5.79")	180 mm (7.09")	38 mm (1.50")	1.5
KF-4313067012	13	100 mm (3.94")	147 mm (5.79")	215 mm (8.46")	38 mm (1.50")	1.8
KF-4318067012	18	120 mm (4.72")	166 mm (6.54")	250 mm (9.84")	38 mm (1.50")	2.5
KF-4324067012	24	150 mm (5.91")	196 mm (7.72")	285 mm (11.22")	50 mm (1.97")	3.3
KF-4332067012	32	200 mm (7.87")	232 mm (9.13")	330 mm (12.99")	45 mm (1.77")	5.4
KF-4347067102	47	200 mm (7.87")	232 mm (9.13")	434 mm (17.08")	45 mm (1.77")	6.8
KF-4375067112	75	300 mm (11.81")	420 mm (16.53")	416 mm (16.37")	45 mm (1.77")	10.2
KF-4585067102	85	300 mm (11.81")	420 mm (16.53")	566 mm (22.28")	45 mm (1.77")	11.10

CHARACTERISTICS for the flow according to ISO 5011

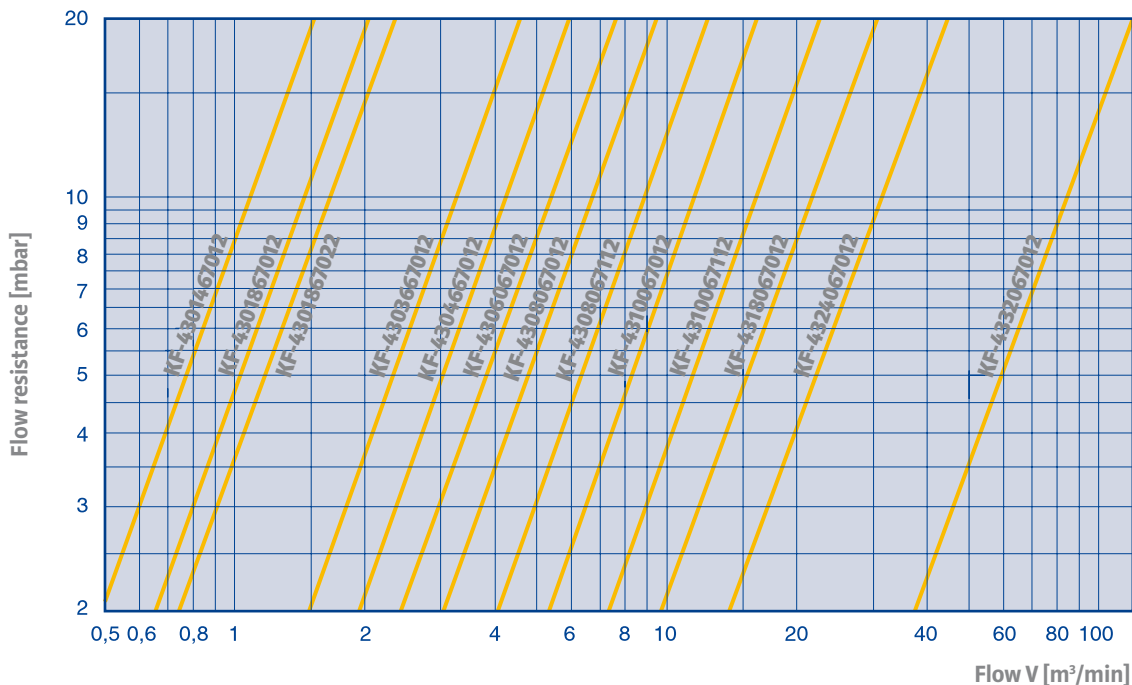

CONTACT

Krone Filtertechnik GmbH
Herbert-Ludwig-Str. 12-14
28832 Achim, Germany
Telephone: +49(0)4202.9769-0
Fax: +49(0)4202.9769-11
Internet: www.krone-filter.de
E-mail: info@krone-filter.de

KFT® wet air filter advice:

Domínik Stoick
Telephone: +49(0)4202.9769-141
E-mail: stoick@krone-filter.de

Marius Krone
Telephone: +49(0)4202.9769-124
E-mail: mkrone@krone-filter.de

